

Gewindestifte

mit Innensechskant Stahl 45H

Kegelkuppe

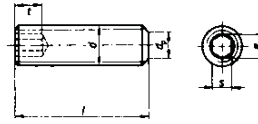

DIN 913

Spitze

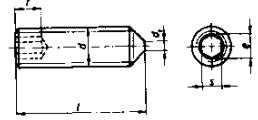

DIN 914

Zapfen

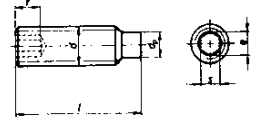

DIN 915

Ringschneide

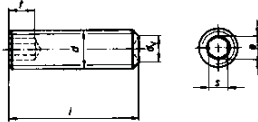

DIN 916

| d | M 3 | M 4 | M 5 | M 6 | M 8 | M 10 | M 12 | M 16 | M 20 |
|-------------|-------|-------|-------|-----------------|-----------------|-----------------|----------------|----------------|--------|
| S Nennmaß | 1,5 | 2 | 2,5 | 3 | 4 | 5 | 6 | 8 | 10 |
| l | | | | | | | | | |
| 3 | 7,77 | | | | | | | | |
| 4 | 6,60 | 6,75 | 8,18 | | | | | | |
| 5 | 6,75 | 5,83 | 7,36 | 9,61 | | | | | |
| 6 | 6,85 | 5,98 | 6,39 | 8,28 | 11,20 | | | | |
| 8 | 7,11 | 6,08 | 6,75 | 7,06 | 9,66 | 16,57 | | | |
| 10 | 7,36 | 6,34 | 6,90 | 7,16 | 8,18 | 14,27 | 30,63 | | |
| 12 | 7,87 | 6,75 | 7,52 | 7,62 | 8,85 | 12,02 | 26,33 | 96,12 | |
| 16 | 8,79 | 7,57 | 8,03 | 8,59 | 9,82 | 13,75 | 22,19 | 51,64 | |
| 20 | 9,36 | 7,82 | 8,85 | 9,71 | 11,66 | 16,21 | 25,41 | 51,03 | 102,26 |
| 25 | 13,45 | 12,27 | 12,99 | 13,24 | 15,29 | 19,02 | 28,33 | 55,22 | 130,38 |
| 30 | | 16,46 | 14,32 | 14,57 | 18,61 | 22,24 | 31,60 | 59,31 | 105,33 |
| 35 | | | | 17,79 | 20,35 | 25,41 | 34,21 | 63,40 | |
| 40 | | | | 21,07 | 25,82 | 31,55 | 37,43 | 66,47 | 117,09 |
| 45 | | | | 24,39 | 30,78 | 40,09 | 42,95 | 75,67 | |
| 50 | | | | 27,46 | 35,53 | 44,48 | 51,13 | 84,87 | 154,92 |
| 60 | | | | | 48,73 | 65,96 | 60,84 | 96,63 | 144,70 |
| 70 | | | | | | 81,30 | 82,32 | 129,87 | 191,22 |
| 80 | | | | | | | 98,68 | 146,23 | 206,05 |
| 90 | | | | | | | 115,55 | 143,16 | 225,48 |
| Paketinhalt | 200 | 200 | 200 | 200 >30: 100 | 200 >25: 100 | 200 >20: 100 | 100 >60: 50 | 100 >35: 50 | 50 |

Gewindestifte

mit Innensechskant - Edelstahl A2

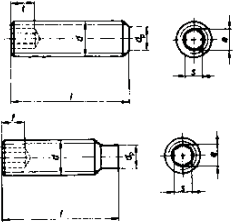

DIN 913
Kegelkuppe

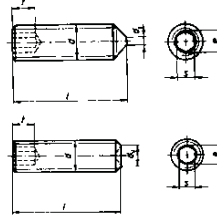

DIN 914
Spitze

DIN 916
Ringschneide

| d | M 3 | M 4 | M 5 | M 6 | M 8 | M 10 |
|-------------|-------|-------|-------|-------|-------|-------|
| S Nennmaß | 1,5 | 2 | 2,5 | 3 | 4 | 5 |
| l | | | | | | |
| 4 | 19,58 | 12,78 | | | | |
| 5 | 20,45 | 12,78 | | | | |
| 6 | 21,17 | 13,75 | 16,62 | 16,62 | | |
| 8 | 21,73 | 14,42 | 17,38 | 17,28 | 22,39 | |
| 10 | 24,44 | 15,03 | 17,90 | 19,28 | 24,29 | 36,46 |
| 12 | | 16,00 | 18,87 | 20,45 | 26,84 | 40,29 |
| 16 | | 18,56 | 20,45 | 22,70 | 30,68 | 46,02 |
| 20 | | 19,84 | 23,01 | 26,84 | 35,79 | 57,78 |
| 25 | | | 25,56 | 28,79 | 41,57 | 58,80 |
| Paketinhalt | 100 | 100 | 100 | 100 | 50 | 50 |

Sechskanthutmuttern

niedrige Form – Edelstahl A2

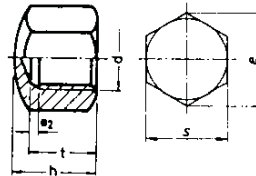

DIN 917

| d | M 3 | M 4 | M 5 | M 6 | M 8 | M 10 | M 12 | M 16 |
|-------------|-------|-------|-------|-------|-------|-------|--------|--------|
| h Nennmaß | | 5,5 | 6 | 9 | 12 | 14 | 16 | 20 |
| t Nennmaß | | 4,4 | 5,2 | 7 | 9,5 | 11 | 13,5 | 17 |
| S Nennmaß | 5,5 | 7 | 8 | 10 | 13 | 17 | 19 | 24 |
| Paketinhalt | 100 | 100 | 100 | 100 | 25 | 25 | 25 | 10 |
| Preis | 22,34 | 21,78 | 24,13 | 28,84 | 44,12 | 76,69 | 102,77 | 201,96 |

Sechskantschweißmuttern

Edelstahl A2

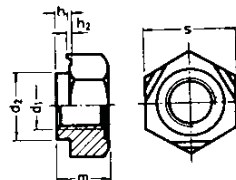

DIN 929

| d ₁ | d ₂ d ₁₁ | e min | h ₁ | h ₂ | m h ₁₄ | s h ₁₃ | Paketinhalt | Preis |
|----------------|-----------------------------------|----------|----------------|----------------|----------------------|----------------------|-------------|-------|
| M 3 | 4,5 | 8,15 | 0,55 | 0,25 | 3 | 7,5 | 250 | 5,52 |
| M 4 | 6 | 9,83 | 0,65 | 0,35 | 3,5 | 9 | 250 | 5,68 |
| M 5 | 7 | 10,95 | 0,7 | 0,4 | 4 | 10 | 250 | 6,60 |
| M 6 | 8 | 12,02 | 0,75 | 0,4 | 5 | 11 | 250 | 9,25 |
| M 8 | 10,5 | 15,38 | 0,9 | 0,5 | 6,5 | 14 | 250 | 10,94 |
| M 10 | 12,5 | 18,74 | 1,15 | 0,65 | 8 | 17 | 100 | 19,94 |
| M 12 | 14,8 | 20,91 | 1,4 | 0,8 | 10 | 19 | 100 | 34,05 |

* Aufpreis Kleinpaket 2,00 € für 100 Stück